

# Your meeting rooms on the first floor of paved courtyard

Room layouts adapted to your specific meeting requirements

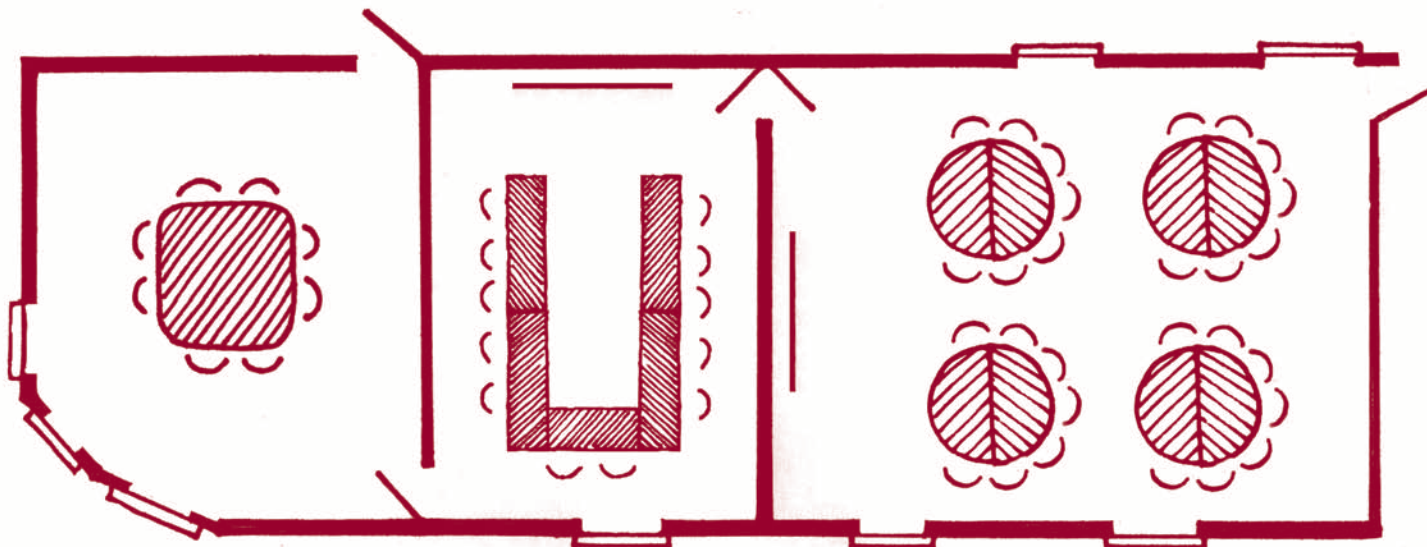

**Azalée**  
(sub-committee)  
(25 m<sup>2</sup>, 5 m x 5 m)

**Taxus**  
12 participants  
(30 m<sup>2</sup>, 6 m x 5 m)

**Rosiers**  
28 participants  
(54 m<sup>2</sup>, 9 m x 6 m)

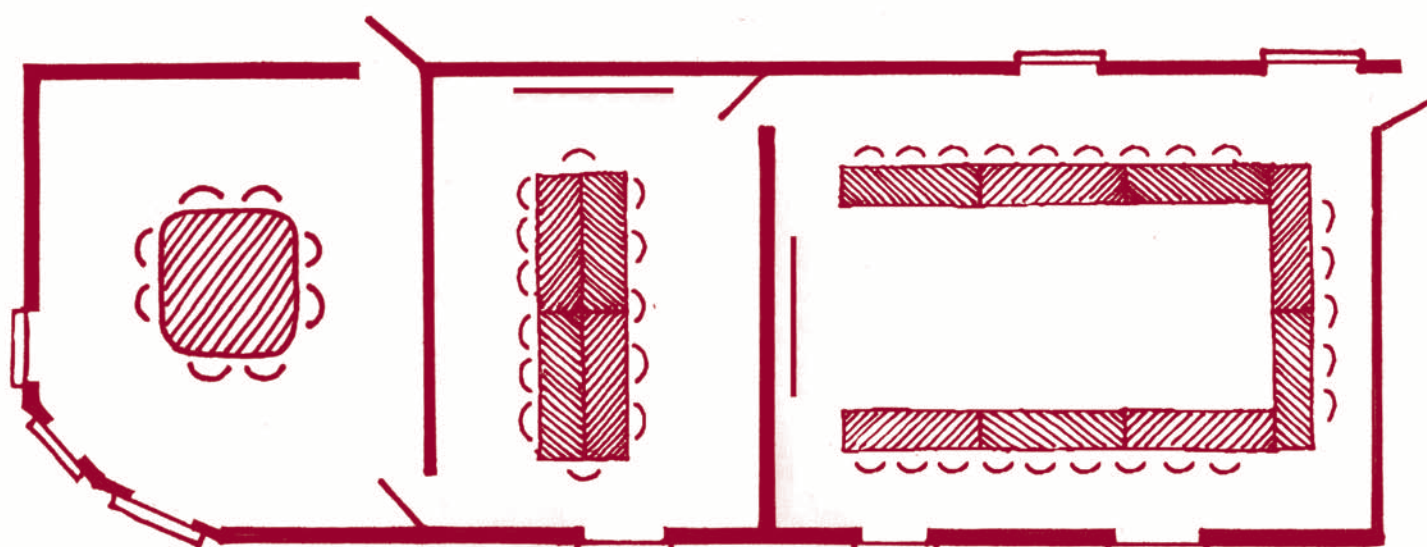

**Azalée**  
(sub-committee)  
(25 m<sup>2</sup>, 5 m x 5 m)

**Taxus**  
14 participants  
(30 m<sup>2</sup>, 6 m x 5 m)

**Rosiers**  
23 participants  
(54 m<sup>2</sup>, 9 m x 6 m)

# Your meeting rooms near the porch... the courtyard of Troène

Room layouts adapted to your specific meeting requirements

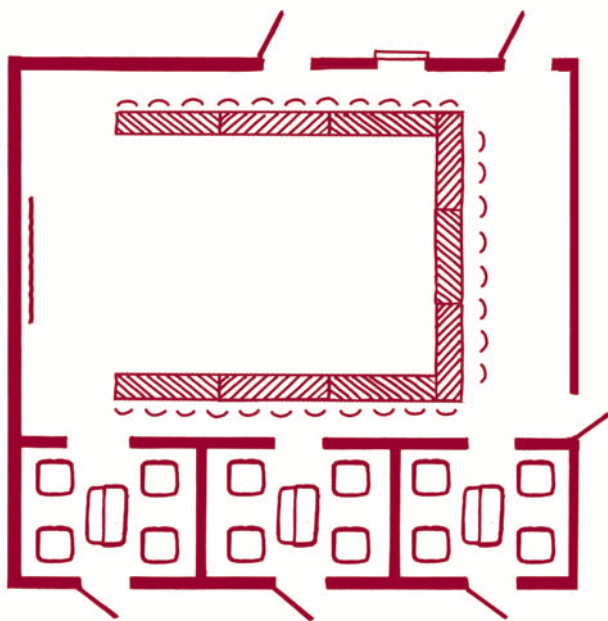

Houx

Buis

Vigne

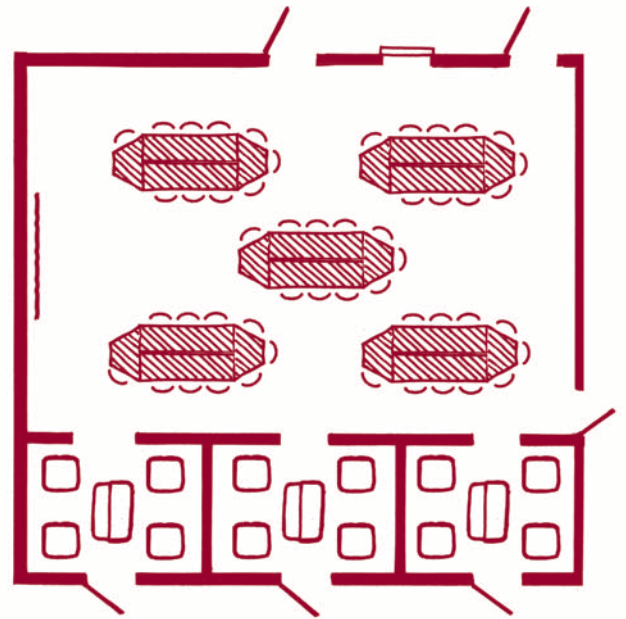

Houx

Buis

Vigne

Troène and 3 sub-committee rooms

30 participants

(77 m<sup>2</sup>, 11 m x 7 m)

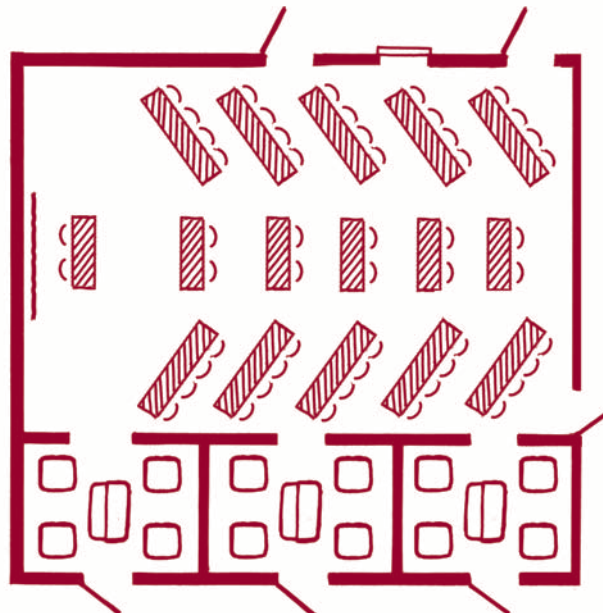

Houx

Buis

Vigne

Troène and 3 sub-committee rooms

50 participants

(77 m<sup>2</sup>, 11 m x 7 m)

# Your meeting rooms in the “Jardins” courtyard

Room layouts adapted to your specific meeting requirements

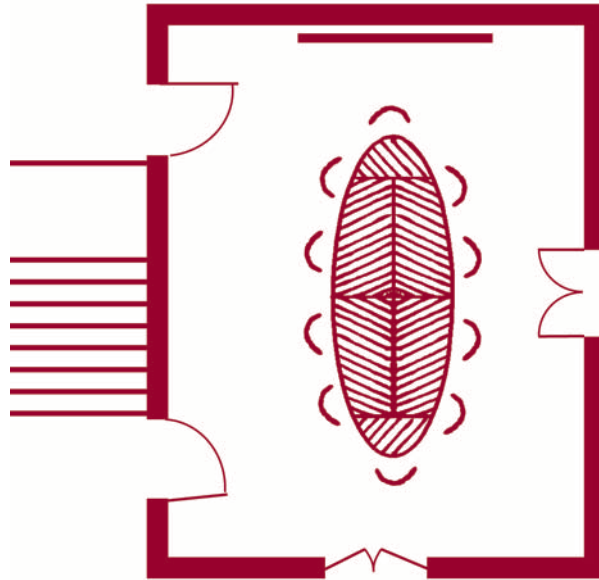

Glycine (Executive meeting room)

10 participants  
(30 m<sup>2</sup>)

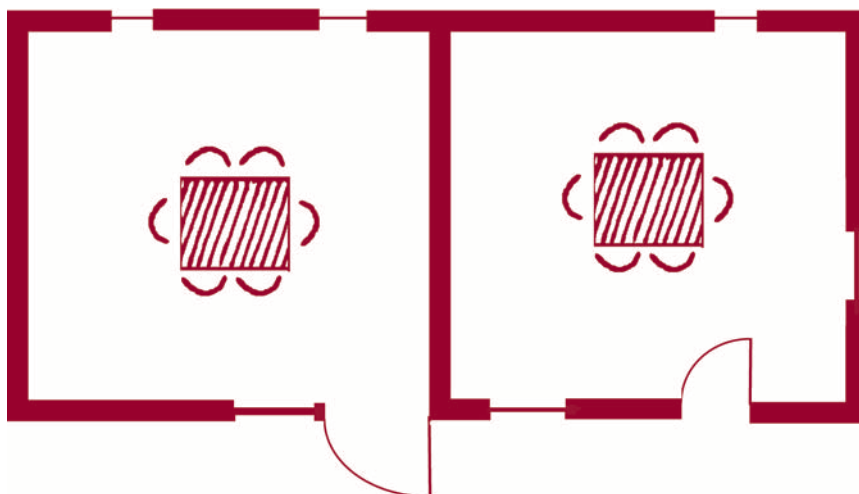

Bois joli  
6 participants  
(20 m<sup>2</sup>)

Bruyères  
6 participants  
(18 m<sup>2</sup>)

## Your meeting rooms in the “Jardins” courtyard

Room layouts adapted to your specific meeting requirements

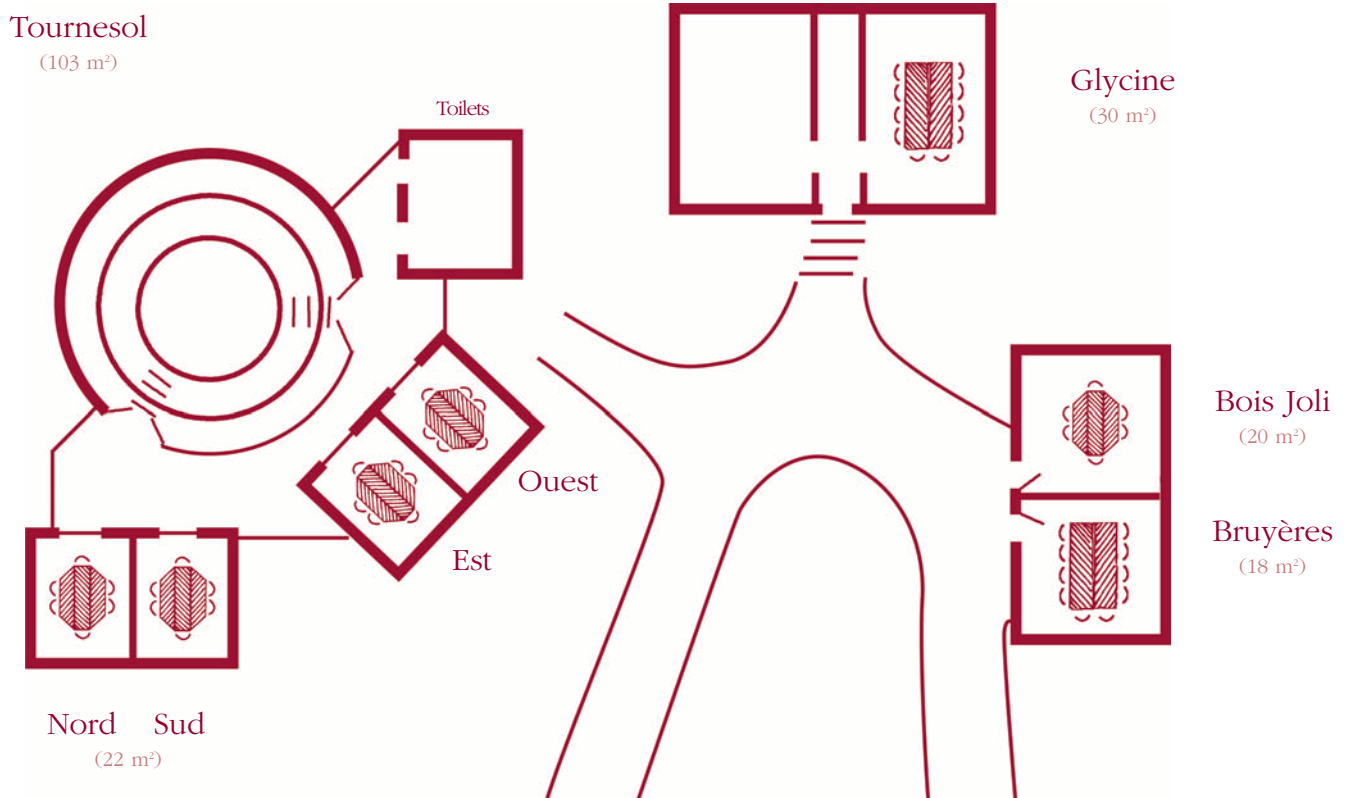

## Your meeting rooms on the first floor of the château

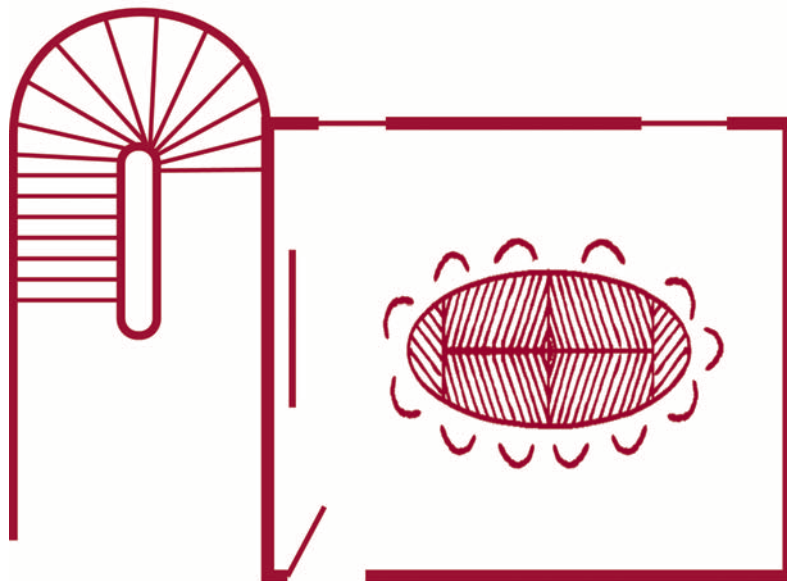

**Amande**  
12 participants  
(24 m<sup>2</sup>, 5,30 m x 4,60 m)